

USING MULTIPLE COST CODES

Haulers have the ability to start a shift with one cost code and change to another cost code for that same shift when needed. Follow the steps below to see how. NOTE: The company for which you are hauling will need to tell you which codes to apply and when to the shifts you are working on.

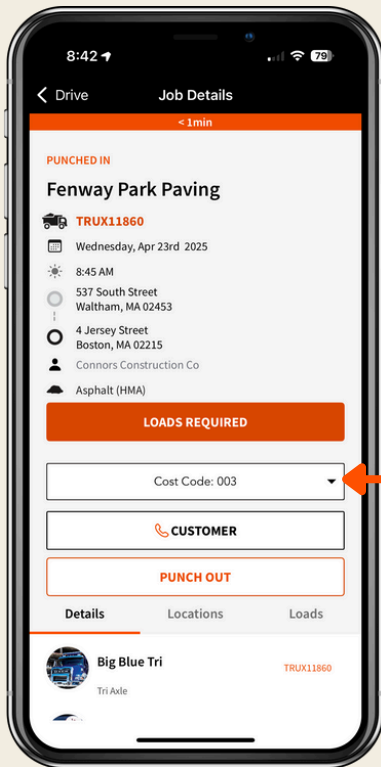

Once loads have been completed for the Primary cost code, the hauler can tap the cost code dropdown list.

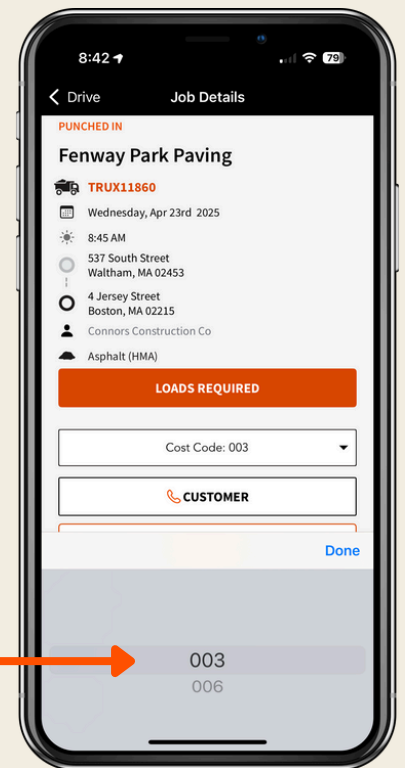

Next, select the new cost code for which they will be performing work and tap Done.

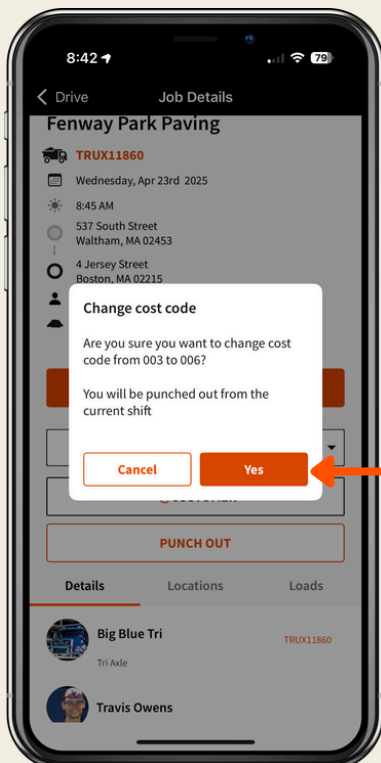

Tap Yes to confirm the cost code change.

You will be automatically punched out of work under the current cost code and punched into work under the newly-selected cost code.